

PLEASE REMEMBER ALL STEELWORK TO BE MANUFACTURED TO A STRUCTURAL ENGINEERS SPECIFICATION. THIS DRAWING IS TO SHOW HOW TO USE THE PLAS-PRO SECTIONS ONLY.

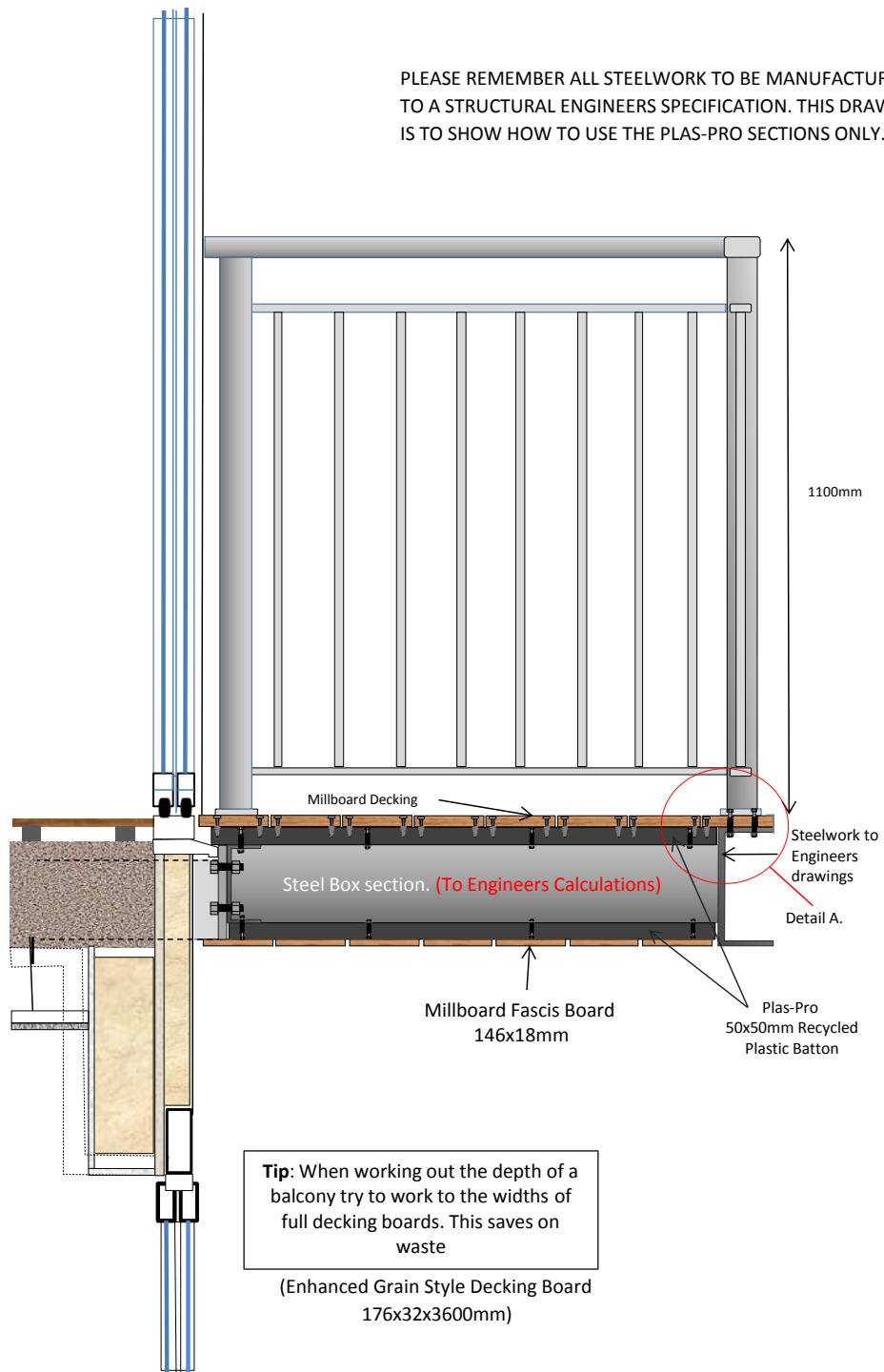

DETAIL. A

Good Practice Note: Mitered deck board joint to be bonded together with Polyurethane glue

PLAN SECTION

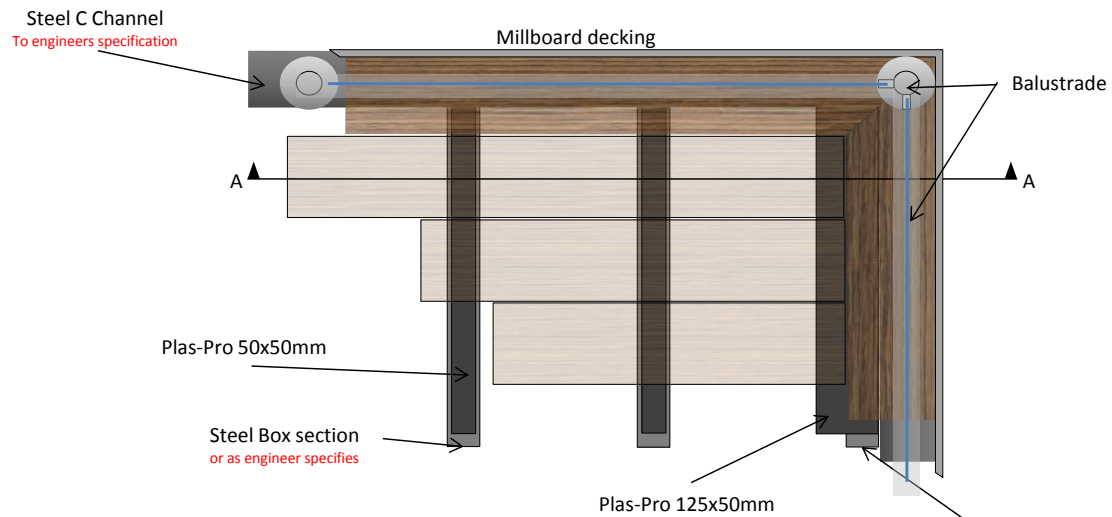

CROSS SECTION

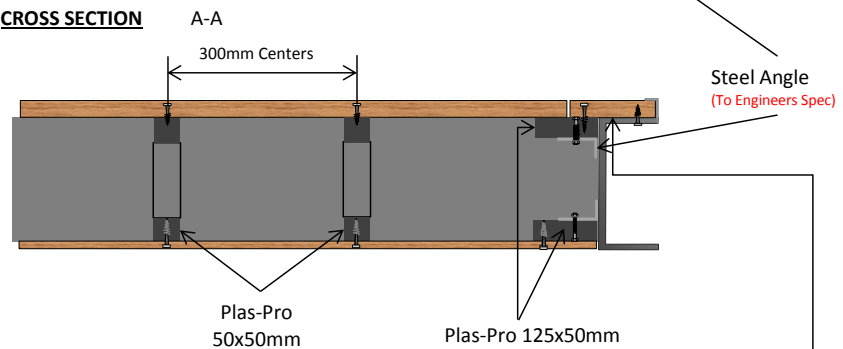

NOTE: Glue the deck board to the steel and also screw it to the 125x50mm Plas-Pro.
Use a MS Polymer type adhesive.
If required it could be screwed from the back through the steel as well